

**normet**

Normet Oy  
Ahmolantie 6  
FI-74510 IISALMI, FINLAND  
Tel +358 (0) 17 83 241  
Fax +358 (0) 17 823 606  
info@normet.fi www.normet.fi

**Spraymec 7110 WPC**

TI 1700497  
DATE 03.07.2012  
PAGE 1 / 4

Concrete sprayer

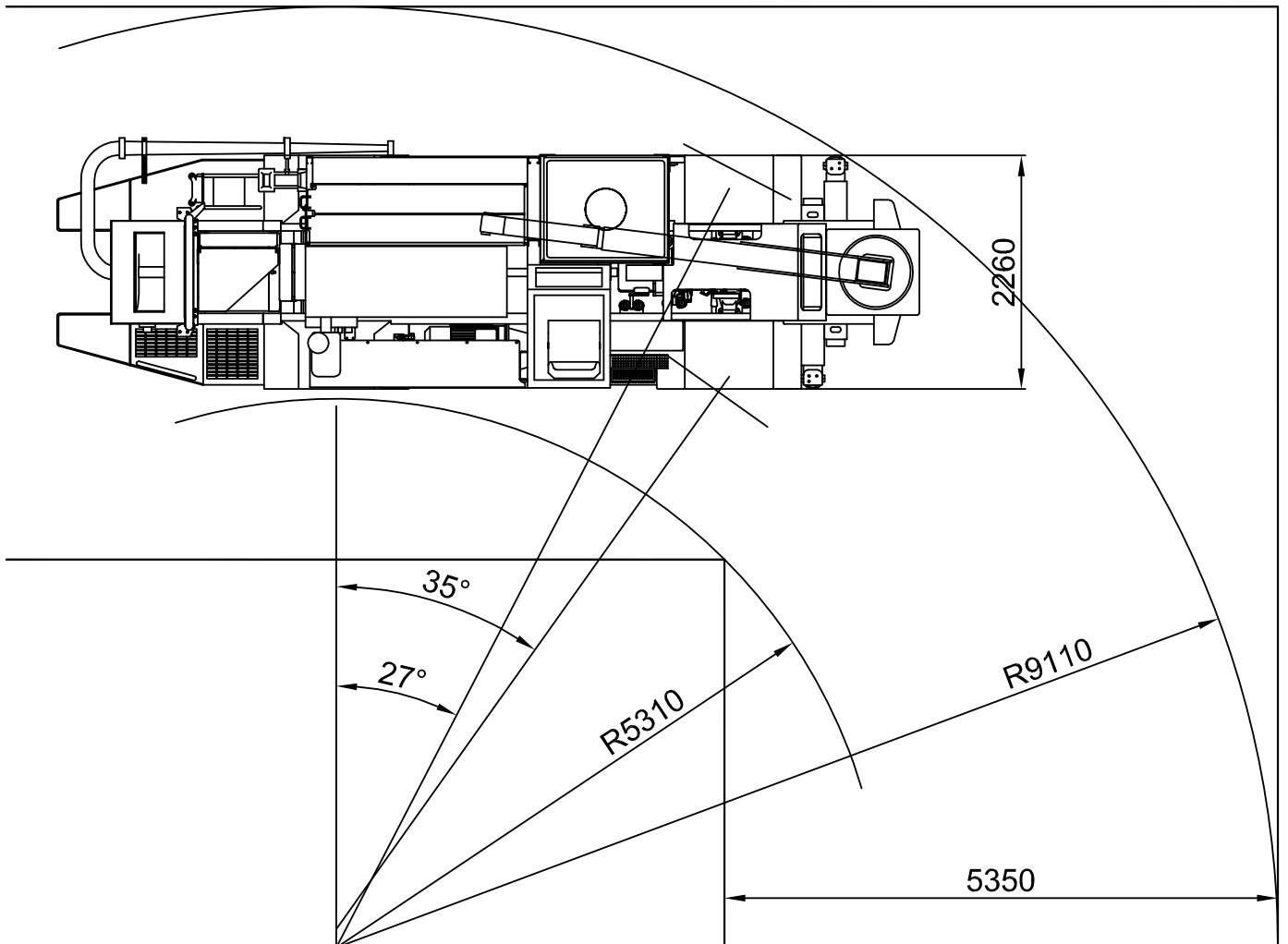
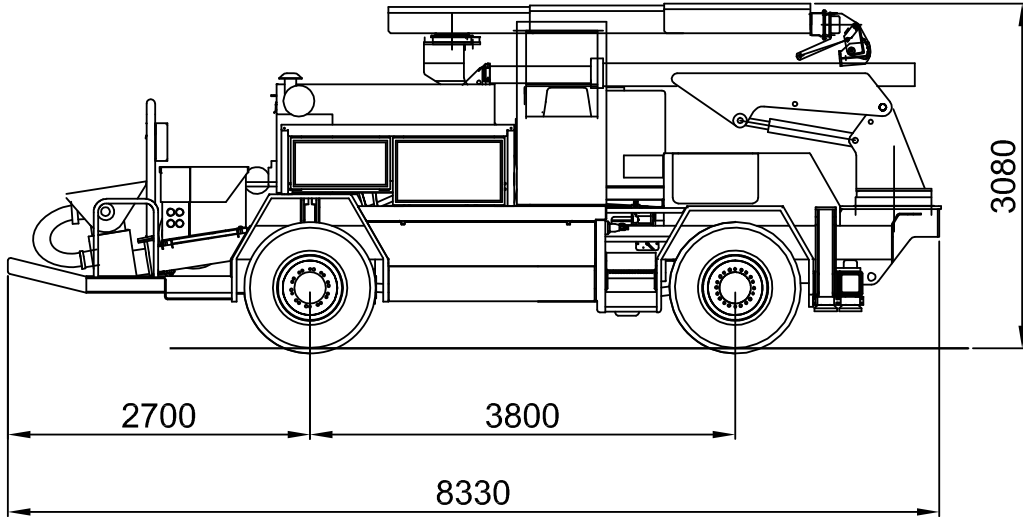

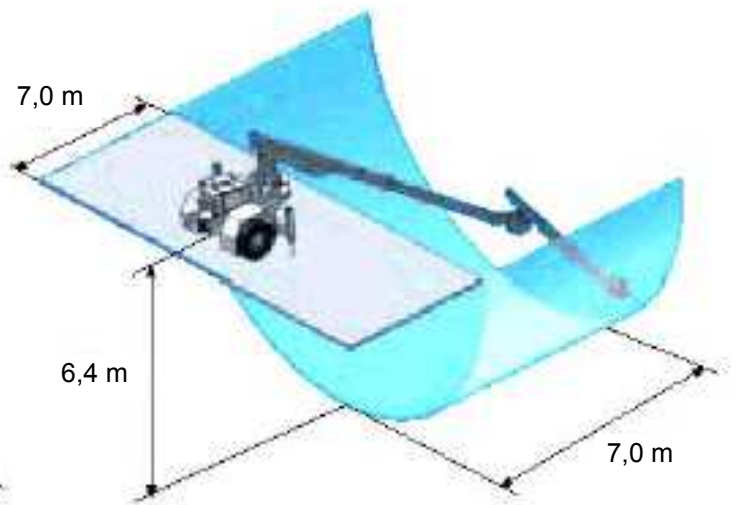
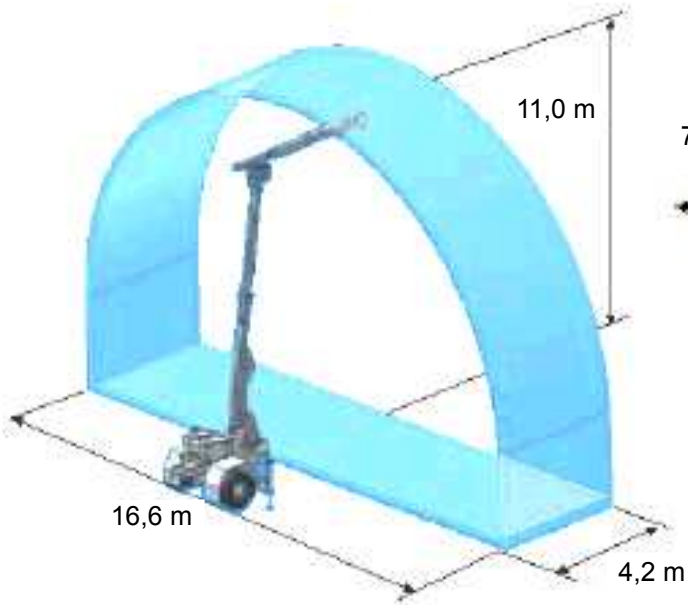
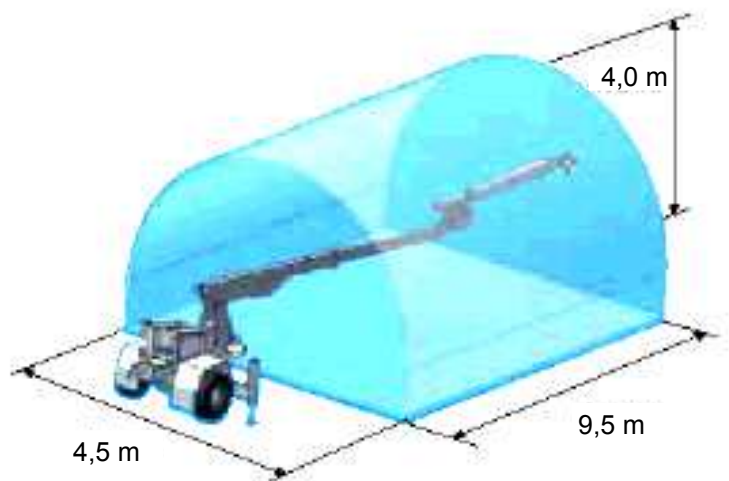
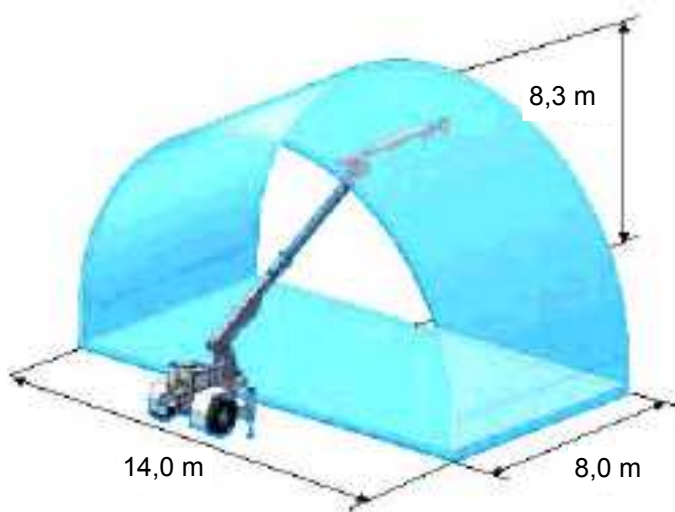
**Max. reach****Min. section**

**SPRAYMEC 7110 WPC**

is a self propelled wheel steered unit for power spraying of concrete in underground caverns and tunnels.

**DIMENSIONS**

Length	8330 mm
Width	2260 mm
Height	3080 mm
Wheel base	3800 mm
Ground clearance	300 mm
Outer turning radius	9110 mm
Inner turning radius	5310 mm
Weight, max. total	16000 kg

**1. SPRAYPUMP**

is the low-wear and low-maintenance double piston pump with the output of 4-30 m<sup>3</sup>/hour. Pumping cylinders with a diameter 200 mm, stroke 750 mm and the large suction openings ensure good suctioning, high pumping pressure enable the conveying of stiff concrete consistencies, with a low water/cement ratio max. aggregate size of 16 mm (also crushed) and all types of fibres in the mix.

**SPRAYPUMP**

Cylinder diameter	200 mm
Cylinder stroke	750 mm
Pumping pressure	57 bar
Pumping capacity	4 - 30 m <sup>3</sup> /h
Practical capacity	25 m <sup>3</sup> /h

**2. ACCELERATOR DOZING SYSTEM NORDOZER 900 H**

is designed using wear and corrosion resistant components compatible with all types of liquid accelerators. The accelerator flow is adjustable by manual control, using digital flow meter, from 60 to 900 litres/h

1000 L space for container	
Dosing rate	60 - 900 L/h

**3. ELECTRO-HYDRAULIC POWER PACK PPE 550**

consist of pumps, oil receiver and filters operates the concrete pump and booms. Boom hydraulics can also be operated diesel-hydraulically.

PPE550	55 kW/400 V 50Hz
--------	------------------

**4. SPRAYBOOM SB 510**

is of universal type and has the following automatic movements: nozzle rotation, telescopic stroke, vertical and horizontal parallel automatics. These automatic functions help the operator to concentrate on the quality of the spraying process and on minimizing the rebound.

Boom coverages	
- lateral	16 m
- vertical	11 m
Telescopic spraying boom	
- basic boom, stroke	3,0 m
- nozzle boom, stroke	2,2 m
Automatic functions:	
- nozzle rotation	
- telescopic stroke	
- horizontal parallel automatics	
- vertical parallel automatics	

**5. SCREW COMPRESSOR**

FAD	10 m <sup>3</sup> min at 7,0 bar
Electric motor	55 kW/400 V

**6. CABLE REEL KKH70**

for power supply of the electrically operated functions, including 100 m of cable.

Power cable	
diam. 3 x 70 mm <sup>2</sup> + ground, L = 100 m	

**7. SUPPORT LEGS**

1 pair in front, hydraulically operated, with lateral extensions.

**8. WORKING LIGHTS**

At boom end	4 x 70 W
	2 x 1000 W
On carrier	2 x 70 W
	1 x 500 W

**9. SAFETY CANOPY**

over the drivers seat fulfills the European safety regulations.

**10. CARRIER NC 70**

is specially designed for underground use. Diesel engine with hydro-dynamic transmission and 4-wheel drive gives max. speed of 18 km/h. Fully enclosed multidisc 2-circuit brakes and parking and emergency brake make operating reliable and safe in the harsh underground conditions.

Diesel engine  
 Driving speed

96 kW  
 max. 18 km/h

**OPTIONAL EQUIPMENT:**

690V/50 Hz electrics  
 1000V/50 Hz electrics  
 Particle filter  
 LED driving lights (4 + 2 pcs)  
 LED working lights on cabin (2 + 2 pcs)  
 Upgrade Nordozer 900 EH  
 4-Wheel steering  
 Concrete casting kit  
 Hydraulic driven water hose reel

**ADDITIONAL EQUIPMENT:**

Soft start system for compressor, 400 V / 50 Hz  
 Soft start system for compressor, 690 V / 50 Hz  
 Hydraulic driven high pressure washer 180 bar / 30 L  
 Rock wall washing system 460 bar / 50 L  
 Rock wall washing system 180 bar / 90 L  
 Electric driven (400V) high pressure washer  
 Fogmaker extinguishing system (manual)  
 Fogmaker extinguishing system (automatic)  
 Ansul extinguishing system (manual)  
 Ansul extinguishing system (automatic)  
 Tempus manually actuated (Non CE)  
 Lubrication system for carrier, boom and pump (Lincoln)  
 1 extra hand held fire extinguisher (12 kg)  
 Tools for maintenance  
 2 pcs wheel chocks with brackets  
 Spare wheel  
 Admixture warming kit 1500 W  
 Admixture container (plastic) 1000 L  
 Admixture mixing kit  
 Radio remote controlled boom  
 Radio control with 4 joysticks  
 Cooling kit for concrete pump oil  
 Cooling kit for compressor oil  
 Iron wheels for container transport  
 Form oil system

**LTC SERVICES:****SPARE PARTS**

**Spare parts package A:** Available for 1000 h of use\*. Include periodical service, most common wearing parts and most critical safety parts.

**Spare parts package B:** Available for 3000 h of use\*. Include periodical service, most common wearing parts and most critical safety parts.

\* Recommendations are based on average hours - can vary a lot depending on work site conditions.

**TRAINING SERVICES**

Available before delivery, at start up and after delivery

**Product training:**

Operation and Maintenance  
 NorSmart  
 Foundation of electrics, hydraulics and mechanics  
 Audit

**Process training:**

Concrete spraying  
 Charging  
 Process audit

**AUDIT SERVICES**

To improve performance of the machines  
 To improve the performance of your processes  
 To help improve the quality of maintenance operations

**SERVICE CONTRACTS**

Spare parts supply programmes  
 Scheduled inspection programmes  
 Supervision programmes  
 Periodic maintenance programmes  
 Machine usage programmes

**LINK ONE**

Link One electronic spare part manuals

**WARRANTY SERVICES**

Extended warranty