

**Terramite Line of Construction Products  
Since 1965**



**Manufacturing Facility:**

Sales, Parts, Warranty

TerraQuip Construction Products Inc.  
600 Goff Mountain Rd  
Cross Lanes, WV 25313

800-428-3772  
304-776-4231  
F 304-776-4845

**Sales:**

sales@terraquipus.com

**Parts:**

parts@terraquipus.com

**Warranty:**

warranty@terraquipus.com

**Corporate Headquarters:**

Accounting, Engineering, Marketing,  
Operations

TerraQuip Construction Products Inc.  
PO Box 9102  
Wichita, KS 67277

316-943-8889

F 316-943-4448

**Accounting:**

accounting@terraquipus.com

**Marketing & Communications:**

marcom@terraquipus.com

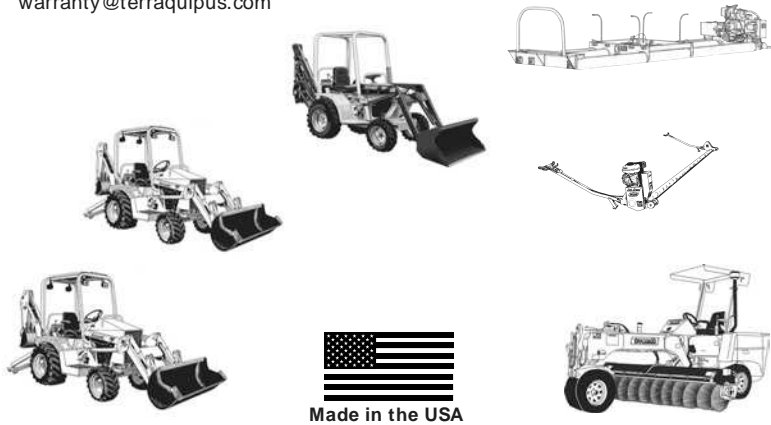

**TerraQuip Construction Products, Inc.**  
Manufacturing Facility: 600 Goff Mountain Rd, Cross Lanes, WV 25313  
Corporate Headquarters: PO Box 9102, Wichita, KS 67277

[www.terramite.com](http://www.terramite.com)

*terramite*  
by TerraQuip®

*H G Screed*



**OPERATOR'S  
MANUAL**



**IMPORTANT!  
READ THIS MANUAL BEFORE  
OPERATING MACHINE**



Manufacturing Facility  
600 Goff Mountain Rd  
Cross Lanes, WV 25313  
800-428-3772

Corporate  
PO Box 9102  
Wichita, KS 67277  
316-943-8889

Revision Date: 2-19-2010

[www.terramite.com](http://www.terramite.com)

# TERRAMITE HISTORY

**TERRAMITE** was founded in 1965 by Kelly G. Cunningham. Mr. Cunningham realized that he could attach the digging part of a tunneling machine he manufactured to the front of a tractor, producing a versatile piece of equipment with a tremendous number of applications. He used the Gravely



Kelly G. Cunningham, Founder

7.6 tractor to power his patented backhoe, creating the Model 1, the world's first compact backhoe. During the years 1965 to 1972, the Model 1 was produced, and a new Model T-2 with an endloader attachment was introduced.

In 1972, Mr. Cunningham purchased property in Cross Lanes, West Virginia which is where the current manufacturing facility is located. Constant improvement in safety, durability, strength, load capacity and digging depth have resulted in the **T-3, T3-15, T4, T5, T5B and T5C**. In 1997 Terramite introduced

the Terramite **T6**, the largest and most powerful compact tractor loader backhoe ever.

1999 was also a year of new products for Terramite. The **TX15 and TX25 Mini Excavators** and the **TSS36 and TSS38 Street Sweepers** were introduced at the 1999 ARA Trade Show in Las Vegas early February. In 2000 the Models T5D and T6 were renamed Models **T7 and T9**, with numerous improvements and features.

Terramite created a concrete finishing product named the **Roller Screed** in 1985. The Roller Screed is used for paving parking lots, entrance ramps, roads, sidewalks and airport runways. The unit can pave from 8' to 32' wide for 8 inch tubes. This brought about the **KG Screed** (previously named the Solo Screed) in the year 2000. This machine will pave from 4' to 16' wide.

In December of 2008, TerraQuip Construction Products, Inc. purchased the assets and rights to manufacture the Terramite line. TerraQuip is part of the Coneqtec group of companies that are based in Wichita, Kansas. As part of the Coneqtec group, the Terramite line will be backed by Coneqtec's engineering, administrative and selling teams.

# SAMPLE WARRANTY

WE WARRANT TO THE ORIGINAL CONSUMER/PURCHASER THAT EACH NEW PRODUCT SOLD BY US WILL BE FREE FROM MANUFACTURING DEFECTS IN NORMAL SERVICE USE FOR A PERIOD OF ONE (1) YEAR FROM DATE OF PURCHASE.

Our obligation under this warranty is expressly limited, solely at our option, to the replacement or repair at the premises of Terramite Corporation, 600 Goff Mountain Road, Cross Lanes, West Virginia 25313, or at a service facility designated by us, of such part or parts as inspection shall disclose to have been defective. This warranty does not apply to defects caused by casualty or unreasonable use (including faulty repairs by others and failure to provide reasonable and necessary maintenance) nor to ordinary wear and tear, while in the possession of the consumer/purchaser.

This warranty is for replacement or repair of defective parts only, and does not provide for replacement of complete products due to a defective part or parts nor does it cover any charges of whatever nature in connection with the replacement of any such defective parts.

We shall not be responsible for special, indirect, incidental or consequential damages of any kind including, but not limited to, labor costs or transportation charges in connection with the replacement or repair of defective parts.

Components such as engines, pumps and batteries which are supplied by other manufacturers, are warranted by the manufacturer's nearest "Factory Service Center" for repair or replacement of those items. However, when necessary, the manufacturer will act as your agent to secure adjustment.

To obtain warranty service, purchaser must bring the product to an authorized Terramite Service facility. For the facility nearest you, contact Terramite Corporation, P.O. Box 7146, Charleston, WV 25356 or telephone (304) 776-4231.

This warranty gives you specific rights and you may have other rights which vary from state to state. This warranty is in lieu of any other warranty, whether written, verbal, expressed or implied and may not be modified or changed by Terramite Distributors or Dealers. This warranty shall be null and void unless the section below has been filled in and the manufacturer's copy of this document is returned to Terramite Corporation, P.O. Box 7146, Charleston, WV 25356 within ten (10) days of the date of purchase by the original owner.

MODEL# \_\_\_\_\_ SERIAL# \_\_\_\_\_ ENGINE# \_\_\_\_\_  
PURCHASED FROM \_\_\_\_\_ CERTIFICATE OF ORIGIN# \_\_\_\_\_  
NAME OF PURCHASER \_\_\_\_\_  
ADDRESS \_\_\_\_\_  
PHONE (\_\_\_\_) \_\_\_\_\_ PERSON TO CONTACT \_\_\_\_\_  
TYPE OF BUSINESS \_\_\_\_\_  
IS THIS YOUR FIRST TERRAMITE PRODUCT? \_\_\_\_\_  
WHAT KIND OF SIMILAR EQUIPMENT DO YOU OWN? \_\_\_\_\_  
\_\_\_\_\_  
OPTIONS \_\_\_\_\_  
DATE OF PURCHASE \_\_\_\_\_  
SIGNATURE \_\_\_\_\_

FILL IN THIS SAMPLE WARRANTY WITH THE INFORMATION REQUESTED ABOVE.  
THIS WILL BE A USEFUL REFERENCE ANYTIME YOU NEED TO ORDER PARTS.

AN ORIGINAL WARRANTY CARD WILL BE SENT WITH MACHINE.

# TRANSLATION CHART

ENGLISH	FRANCAIS	DEUTSCH	ESPAÑOL
axle shaft	arbre d'essieu	Achsenwelle	barra eje
bearing	palier	Lager	cojinete
bolt	boulon	Bolzen	bulón
cable	câble	Kabel, Seil	Cable
carburetor	carburateur (mélangeur)	Vergaser	carburador
chain	chaînes	Kette	cadena
choke	enrichisseur	Startklappe	ahogador
control	commande	Steuerung, Betätigung	control
cotter pin	goupille fendu	Spint	chaveta
decal	décalque, décalcomanie	Abziehbild, Beschriftung	calcomania
detachable	amovible	abnehmbar, geteilt	separable
dipstick	jauge baïonnette	Messstab	varilla medidora
drive axle	essieu moteur	Antriebsachse	eje motriz
enclosure	carter, carénage	Umrandung, Gehäuse	compartimiento
end	terminal, extrémité	Ende	extremo
engine	moteur	Motor	motor
exhaust	échappement	Auspuff	escape
filter	filtre	Filter	filtro
forward	en avant	vorwärts	adelante, hacia adelante
front	avant	vorne, Front	frente, parte delantera
gear	pignon, engrenage	Zahnrad, Gang	engranaje
guard	protecteur	Schutz, Abdeckung	protector
handle	poignée	Griff, Handgriff	asa
housing	boîtier, carter	Gehäuse	caja
key	clé, clavette	Schlüssel, Keil	llave
lever	levier	Hebel	palanca
locknut	contre-écrou	Kontermutter, Sicherungsmutter	tuerca de traba
lockwasher	rondelle d'arrêt	Federring	arandela de seguridad
motor	moteur	Motor, elektr.	motor
mount	support	anbauen, montieren	montar
muffler	silencieux d'échappement	Schalldämpfer	silenciador
oil	huile	Öl	aceite
oil level	niveau d'huile	Ölstand	nivel del aceite
oil filter	filtre à huile	Ölfilter	filtro de aceite
pin	goupille, axe	Bolzen, Stift	pasador
rear	arrière, AR	rückwärts, hinten	posterior, trasero
repair	réparation	Reparatur	reparación
reservoir	réservoir	Tank	depósito, tanque
reverse	marche AR	Rückwärtsgang	marcha atrás, reverso
right hand (RH)	côté droit, à droit	rechts	lado derecho (L.D.)
roller	galet	Laufrolle	rodillo
seal-o-ring	joint torique	O-Ring-Dichtung	anillo, anillo de estancamiento
setscrew	vis de fixation	Gewindestift	tornillo de traba, tornillo prisionero
shaft	arbre, axe	Welle	eje, mango largo, rastágo
shield	bouclier, écran de protection	Abdeckung, Schild	protector
shroud	panneau, plaque	Abdeckplatte	cubierta, refuerzo de ventilador
spark plug	bougie d'allumage	Zündkerze	bujía
spindle	pivot, fusée, broche	Spindel, Achszapfen	punta de eje
springs	ressort	Feder	resortes
sprocket	barbotin	Antriebsrad	rueda dentada
starter	démarrreur	Anlasser	arranque
steering	directon	Lenkung	dirección
tube	tuyau, tube, gicleur	Rohr, Schlauch	tubo
tubing	canalisations	Rohr, Schlauchleitung	tuberías, tubos
washer	rondelle	Unterlegscheibe	aradela
water	eau	Wasser	agua
wheel	roue	Rad	rueda
wrap	revêtement, enveloppe	Hülle	envolver, envoltura

# FAMILY OF PRODUCTS

## Compact Tractor Loader Backhoes



**T5C**



**T7**

**T9**

## Roller Screeds



## Towable Street Sweepers



VISIT OUR WEB SITE  
[www.terramite.com](http://www.terramite.com)

## SAFETY INFORMATION

These safety precautions should be followed at all times. Failure to follow these safety precautions could result in serious injury or death to you and others. You must review these precautions with all personnel who will be using or near this machine.



**WARNING:** Gasoline is flammable and it can explode if ignited. Store it only in approved containers away from sparks or flames. Do not fill the fuel tank while the engine is hot as the fuel may ignite. Do not use gasoline as a cleaning agent.



**WARNING:** The engine can get hot during operation. To avoid burns, do not touch the engine while it is running or after it is turned off. Do not operate the engine with guards removed.



**WARNING:** Before servicing the engine or equipment, always disconnect the spark plug lead to prevent the engine from starting accidentally. Bind the leads to prevent sparks that could cause fires. Make sure the machine is in neutral.



**WARNING:** Engine exhaust gases produce poisonous carbon monoxide, an odorless and colorless gas. If inhaled it can cause death. Never run an engine in an enclosed space.



**WARNING:** Keep hands, feet, hair, and clothing away from all moving parts to prevent injury. Never operate engine with covers, shrouds or guards removed.



**WARNING:** Some of the components on the machine are heavy. Obtain some assistance before beginning any task that requires removal of heavy parts.

## TAIL SECTION PARTS

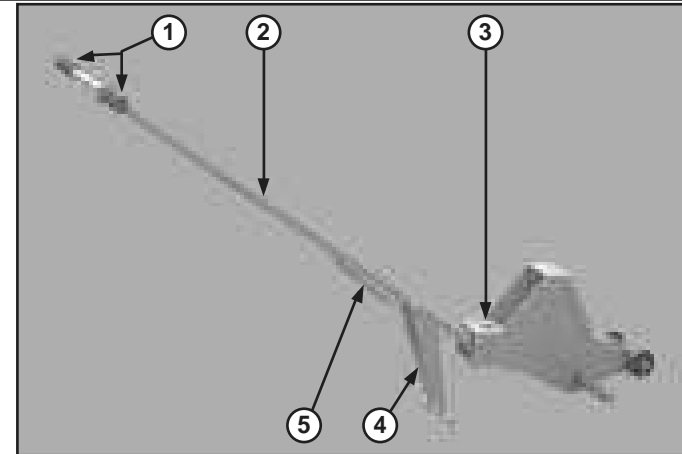

ITEM	PART NUMBER	DESCRIPTION
1	37009	Handle Grips
2	32029	Handle Assembly
3	30095	Pivot Pin
4	38151	Kick Stand
5	37010	Spring

## TAIL SECTION PARTS

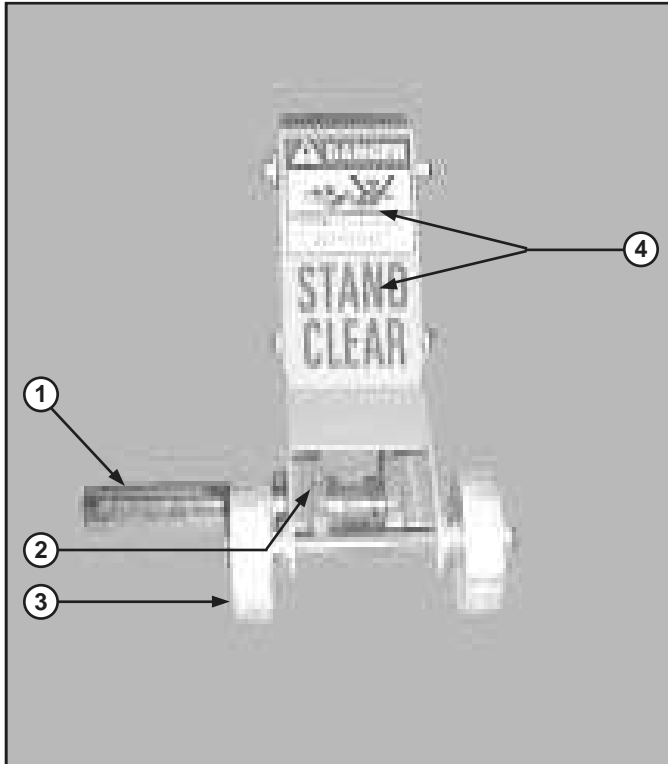

ITEM	PART NUMBER	DESCRIPTION
1	32035	Pin, Tail, KG Screed
2	38667	Flange Bearing, KG Screed
3	33036	Wheels
4	14289	Decal Set, KG Screed
TUBE ENDS (NOT SHOWN)		
	32020	4" Tube Ends
	32034	5" Tube Ends
	32044	6" Tube Ends



**DANGER:** Do not attempt to start or operate machine except from the operator's position.



**DANGER:** Do not leave the machine running unattended.



**DANGER:** Only operate the control levers from the operator's position.



**DANGER:** When in operation allow only the operator to control the machine.



**DANGER:** The tube assembly can be heavy. It may be necessary to use a lifting device.



**DANGER:** The tube assembly can roll very easily. When being assembled the tube must be prevented from rolling from the work area.



**DANGER:** Welding and grinding produce sparks and dangerous gas. Only qualified personnel are to perform such tasks.

## SAFETY RULES

Operator safety is extremely important in the design of your KG SCREED. Guards, shields and other safety features are built in wherever possible. You can avoid accidents by **OBSERVING** and **ENFORCING** the **SAFETY RULES** listed. Make sure everyone knows and understands these rules. Failure to follow and observe these safety rules may lead to serious injury or death:



**DANGER:** DO NOT ATTEMPT TO START OR OPERATE MACHINE EXCEPT FROM THE OPERATOR'S POSITION.

**! DANGER:** DO NOT LEAVE THE MACHINE RUNNING UNATTENDED.

**! DANGER:** ONLY OPERATE CONTROL LEVER FROM THE OPERATOR'S POSITION.

**! DANGER:** WHEN IN OPERATION, ALLOW ONLY THE OPERATOR TO CONTROL THE MACHINE.

**! DANGER:** WHEN TRAMMING THE MACHINE, MOVE ALL PERSONNEL FROM ITS PATH.

**! DANGER:** PRIOR TO USING THE MACHINE, CHECK THAT ALL OBSTRUCTIONS ARE CLEAR OF THE PATH OF THE OPERATOR, HELPER, AND MACHINE.

**! DANGER:** PRIOR TO USING THE MACHINE, CHECK THAT THE OPERATOR AND HELPER ARE BOTH FAMILIAR WITH THE OPERATION OF THE MACHINE.

**! DANGER:** VERIFY THAT THE OPERATOR KNOWS TO ALERT THE HELPER PRIOR TO MOVEMENT BEFORE THE OPERATOR ENGAGES THE DRIVE MECHANISM.

**! DANGER:** VERIFY THAT THE HELPER KNOWS TO BE AWARE OF THE SIGNAL FROM THE OPERATOR WHEN THE OPERATOR IS ABOUT TO ENGAGE THE MACHINE.

**! DANGER:** KEEP ALL PERSONNEL FROM THE FORWARD AND REVERSE PATH OF THE MACHINE.

## POWER UNIT PARTS

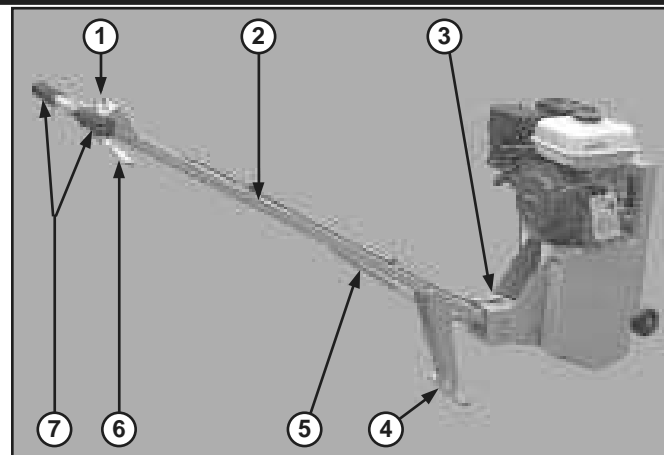

ITEM	PART NUMBER	DESCRIPTION
1	77062	Switch, On/Off
2	32029	Handle Assembly
3	30095	Pivot Pin
4	38151	Kick Stand
5	37010	Spring
6	31053	Throttle Lever
7	37009	Handle Grips

*H G Sreed*

## POWER UNIT PARTS\*

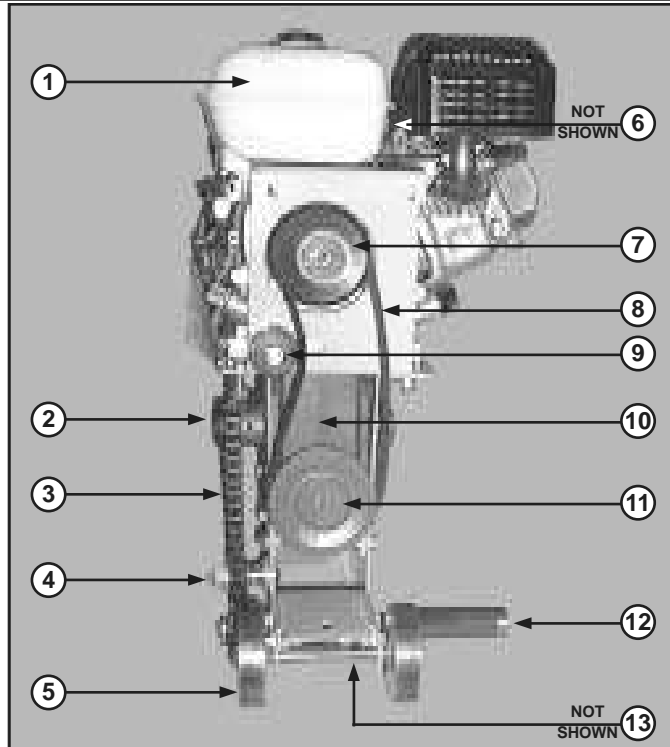

ITEM	PART NUMBER	DESCRIPTION
1	33009	4HP, Honda Engine
2	38664	Sprocket, Engine
3	38668	#40 Roller Chain
4	38666	Sprocket, Idler
5	33036	Wheels
6	31057	Drive Cable (Not Shown)
7	31052	Centrifugal Clutch
8	38669	4L290 V-Belt
9	38665	Idler Bearing
10	36003	Gearbox, Single
11	38663	V-Belt Pulley
12	32036	Pin, Motor, KG
13	38667	Flange Bearing, KG (Not Shown)

\* (SHOWN WITH GUARDS REMOVED)

## SETUP

Your machine consists of 4 basic components:

1. **POWER UNIT**...Consists of the engine and operator's handle.
2. **ROLLER**...Consists of a single tube that rotates away from the operator's position.
3. **TUBE ENDS**...Attach the power and tail unit to the roller, and attach by bolting in place. Tube ends are reusable.
4. **TAIL ASSEMBLY**...Provides support for the roller, and a handle assembly necessary for the helper.

## ASSEMBLY



**WARNING:** It is important that the machine be assembled at the job site, for ease and safety.



**WARNING:** Review the safety section before beginning.

Once you have identified the Power unit, roller tube ends and Tail assembly, place the roller on a flat surface. Insert the tube ends into the tube, make sure that each is in place, then tighten each bolt. Liberally lubricate the hex shafts with grease. Insert the Power unit, then the Tail assembly onto the roller. Once completed, insert the cotter pins into the roller and bend them. The machine is ready for use.

## DISASSEMBLY

Disassembly is the reverse of assembly. Stop the engine, remove cotter pins, remove power unit and tail unit from roller. Machine is disassembled.

## OPERATION

Once the machine has been assembled and placed on the paving forms, check fuel and motor oil levels. Fill as needed.

Note the position of the engine fuel valve, choke, throttle lever, and engine on/off switch.

Have the helper hold the tail assembly handle.

### START ENGINE

To start the engine it may be necessary to use the choke lever. Pull the starter rope. After the engine starts, reset the choke lever. Allow the engine to warm up for about 2 minutes.

**Reminder: Do not leave Solo Screed unattended.**

 **DANGER:** Machine is to remain motionless during starting. If not, stop engine and refer to service section.

**NOTE:** The roller will not spin and the machine will not move until the spinning lever is depressed.

The operator then takes his position at the control lever at the end of the control handle. The operator then signals to the helper to prepare to hold back on the machine. Once the operator receives notice that the helper is ready, then the operator engages the spinning lever. At this time the roller will rotate away from the operator and helper. The operator and helper pull against the rotation of the machine and pull the machine into the placed concrete with the roller spinning.

## TECHNICAL SPECIFICATIONS

Horsepower.....	4 HP
Tube Rotating Speed.....	230 RPM (at maximum engine speed)
Belt.....	4L290 (1/2" pitch x 29" long)
Chain Pitch.....	#40
Cotter Pin Size.....	5/16" x 2-1/2"
Power Unit Weight.....	113 Pounds
Physical Size (Assembled).....	60"L x 15"W x 36"H
Tail Unit Weight.....	38 Pounds
Physical Size (Assembled).....	60"L x 6-1/2"W x 36"H
Tube Weight* 4".....	10.8 lbs. per ft.
5".....	14.6 lbs. per ft.
6".....	18.9 lbs. per ft.
*Tubing is schedule 40 electric welded.	
End Cap Torque.....	58 ft/lbs
U.S. Shipping Weight.....	250 lbs.



## CUSTOMER SATISFACTION

Customer safety and satisfaction through quality engineered and quality manufactured equipment, with service after the sale is our policy. Should you need a part, we strive to ship the same day.



*We sincerely appreciate your business and thank you for choosing a TERRAMITE product. We WILL provide the service necessary for profitable and enjoyable ownership of your KG Screed.*

**NOTE:** The spinning speed of the roller is directly related to the engine speed. To obtain faster roller rotation depress the spinning lever. To decrease roller rotation release the spinning lever.

**NOTE:** For ease of use and complete understanding of operation, its suggested that the operator and helper practice the operation of the machine prior to arrival of concrete.

## OPERATING TIPS

As with any piece of equipment, it takes a short period of time before an operator and helper become efficient with the machine. Although you as an operator/helper will have a certain way you wish to do a job, below are some basic guidelines to help get started.

- Place concrete uniformly in front of the machine. Try to avoid deposits of concrete in one spot. This helps keep the machine straight.
- Keep in mind that the KG Screed operates on the top edge of the concrete form, not the concrete itself. Be sure that all concrete form supports are below screed running level.
- Keep the work path clear of anything to trip over, also keep all loose debris sweep clear, such as dirt, gravel, sand, etc.
- Do not allow unfinished concrete more than a few feet ahead of the machine. Remember, this is a concrete paving machine, not a bulldozer. This will greatly reduce the effort to the operator and helper, and keep concrete trucks at your site to a minimum.

- As one truck leaves and before the next arrives, make several repeated passes over the smoothed concrete. Continue this until only a small amount of concrete is being picked up by the roller. This should be about 4 or 5 passes.
- Avoid spillage over the roller. This minimizes the machine from hopping over the concrete.
- During operation it will be necessary to sweep or shovel excess concrete from in front of the machine.

## LUBRICATION AND PERIODIC SERVICE

### POWER SYSTEM - OIL

- Oil level is marked on the fill tube for the engine. Add recommended oil types as needed. Refer to engine service manual.
- To drain motor oil, remove the plug from the oil pan. Allow oil to drain completely. Refill with recommended oil.

### POWER SYSTEM - AIR FILTER

- Refer to the engine service manual for recommended period of replacement.

### BEARINGS SERVICE

- Grease the bearings every 100 hours of operation.

### DRIVE MECHANISM

- Check oil level weekly.
- Replace first 100 hours, and then every 500 hours.

## SERVICE PROCEDURES

Listed below are procedures that address problems that may be encountered in the field. These guidelines are to correct and/or identify reasons for incorrect performance.

**PROBLEM:** Machine doesn't move or won't stay in neutral.

1. Turn off engine and allow it to cool, remove engine assembly from roller.
2. Disconnect spark plug wire, remove front drive cover and side cover. Check condition of the drive belt, upper and lower pulleys, and drive pulley. Replace as needed. Refer to parts section.
3. Work the drive cable with the operator's handle. As the handle is being engaged the throttle on the engine should move. If not, replace the drive cable. Refer to parts section.
4. Reassemble covers to the machine.
5. Start engine.



**DANGER:** Be aware of rotating shaft. Failure to observe this safety precaution may result in serious injury or death.

6. Check operation. If correct, stop engine and reassemble machine. If not operating properly then proceed to next step.
7. Repeat steps 1 and 2. Remove side cover. Check conditions of the drive chain and chain adjustment. Replace and adjust as necessary. Refer to parts section.
8. Repeat steps 4 through 6.
9. If operation is not correct after these steps, stop and refer to manufacturer for assistance.